

HERTZ

SPL/Show



SOUND PACKS FOR MOTORCYCLES

HARLEY-DAVIDSON® 1998-2024+

JANUARY 2026

Elettromedia-USA 16691 Noyes Ave Irvine, California 92606 USA 877.567.3030

SPL SHOW

HERTZ SOUND PACKS

1998-2013 HARLEY-DAVIDSON® MOTORCYCLES

HSP3-13

MSRP: \$2,965.00

H-D® Motorcycles 1998 - 2013: Plug and Play 4 Speaker Kit with Saddlebag 6x9 Kit includes: SP4.900 amplifier, HD13AP amplifier mounting bracket, SX165 NEO Coax Speakers, SX690 NEO.1 Coax Speakers, HTHP13 T-Power Harness, HD13H Saddlebag Lid Kit with Speaker Harness and your choice of SG or RG speaker grilles.

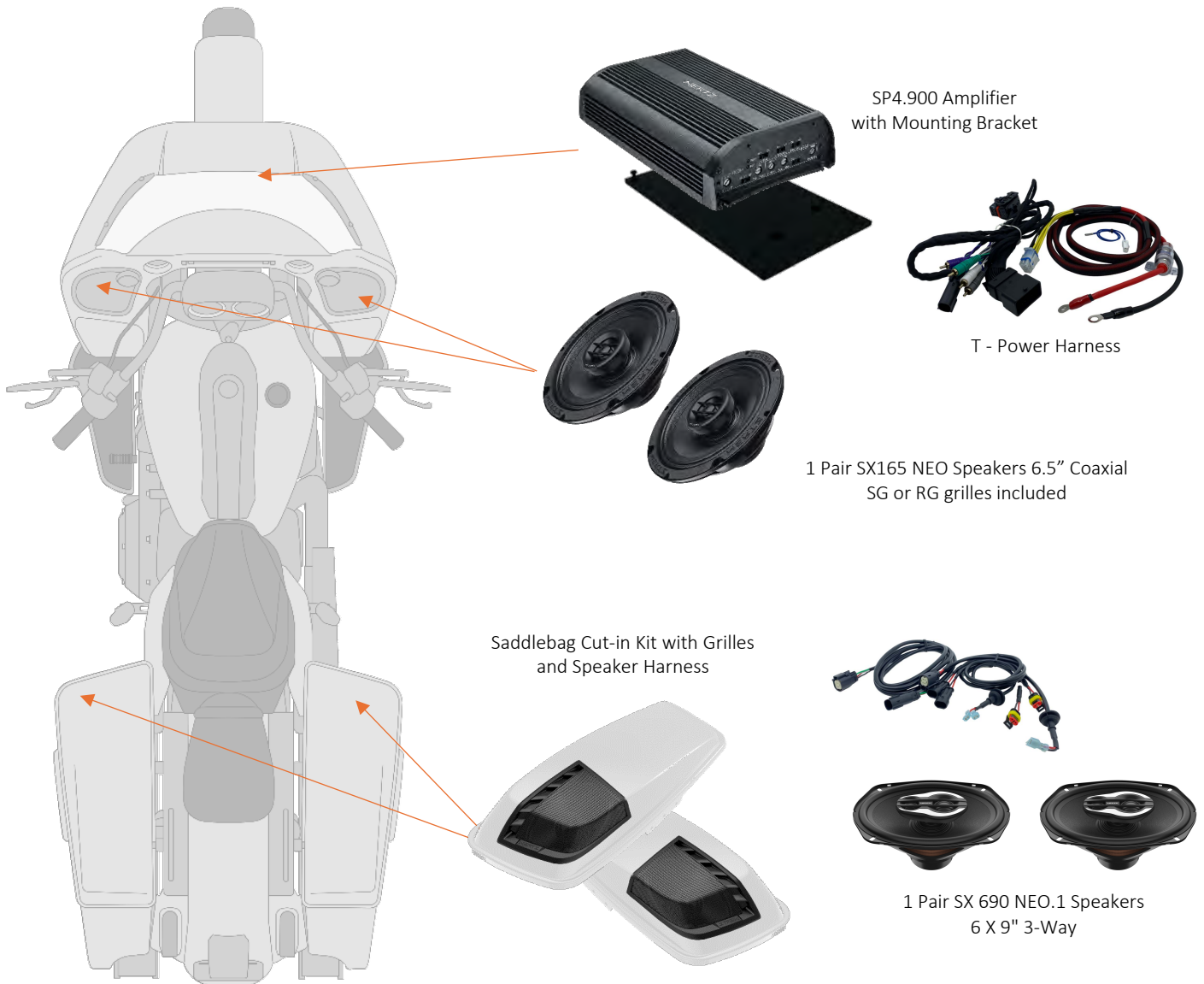

SPL SHOW

HERTZ SOUND PACKS

1998-2013 HARLEY-DAVIDSON® MOTORCYCLES

HSP2-13

MSRP: \$2,420.00

H-D® Motorcycles 1998 - 2013: Plug and Play Four Speaker Kit for bikes equipped with Touring Packs includes: SP4.900 amp, HD13AP amplifier mounting bracket, SX 165 NEO Coax Speakers, SV165 NEO Midrange Speakers and HTHP13 T-Power Harness and your choice of SG or RG speaker grilles.

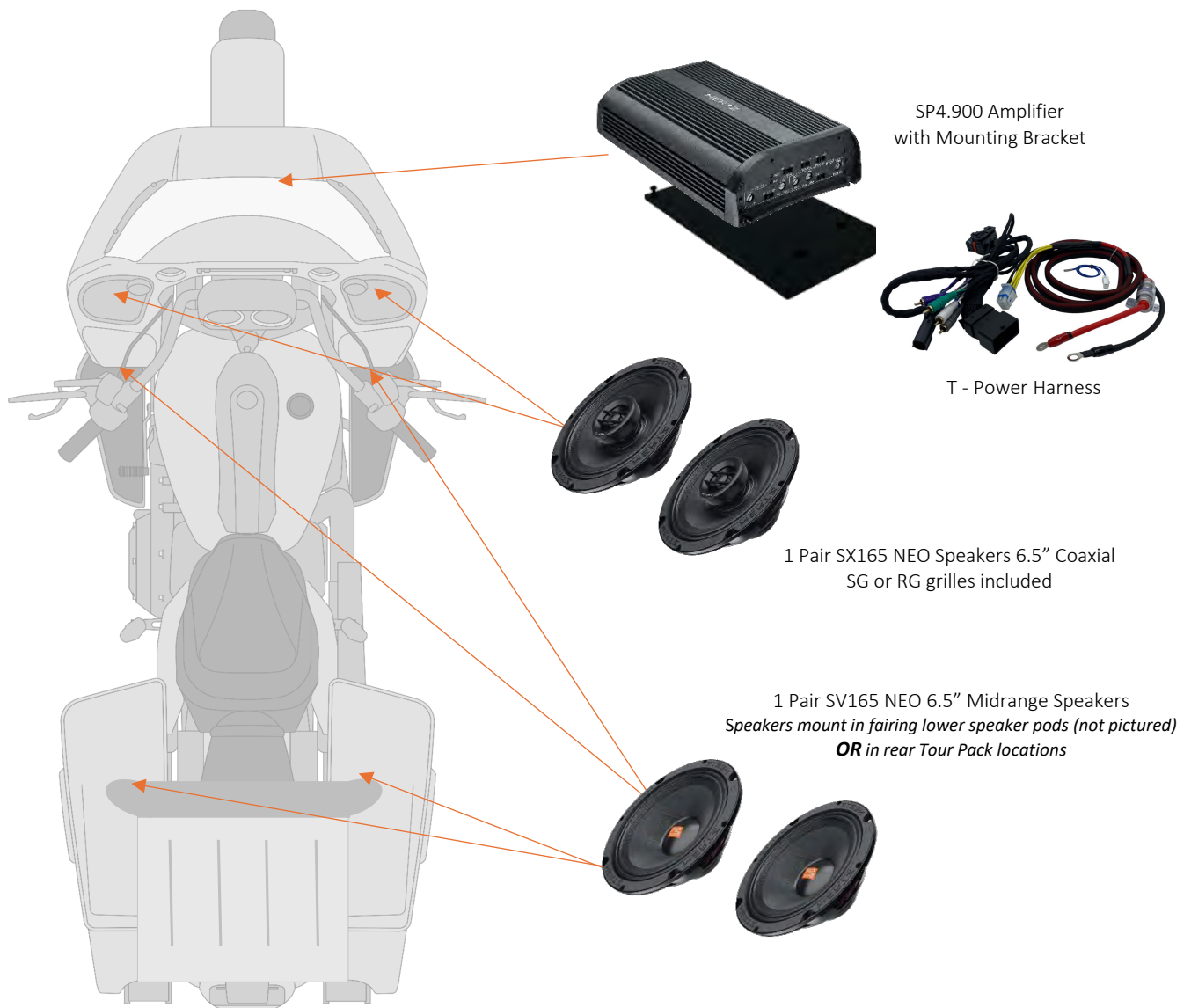

SPL SHOW

HERTZ SOUND PACKS

1998-2013 HARLEY-DAVIDSON® MOTORCYCLES

HSP1-13

MSRP: \$1,940.00

1998 - 2013 Plug and Play Front Speaker Kit with SP4.900 amp, SX 165 NEO Coax Speakers, HTHP13 T-Power Harness and amplifier HD13AP mounting bracket and your choice of SG or RG speaker grilles.

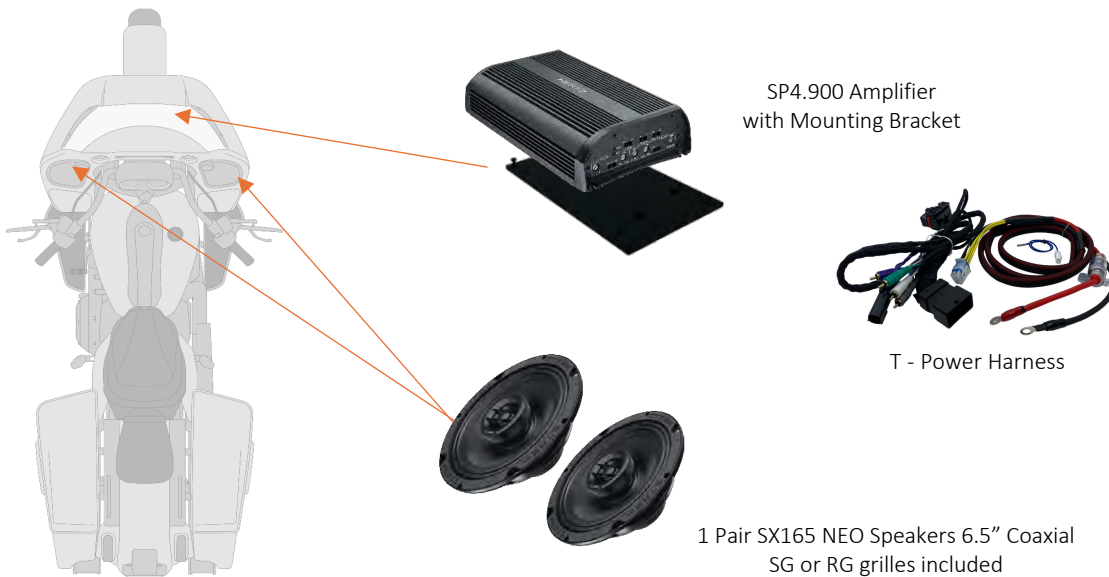

HD13H 6x9

MSRP: \$1,075.00

1998 - 2013 Saddle Bag Lid Kit with Speaker Harness and SX690 NEO.1 3-Way Speakers.

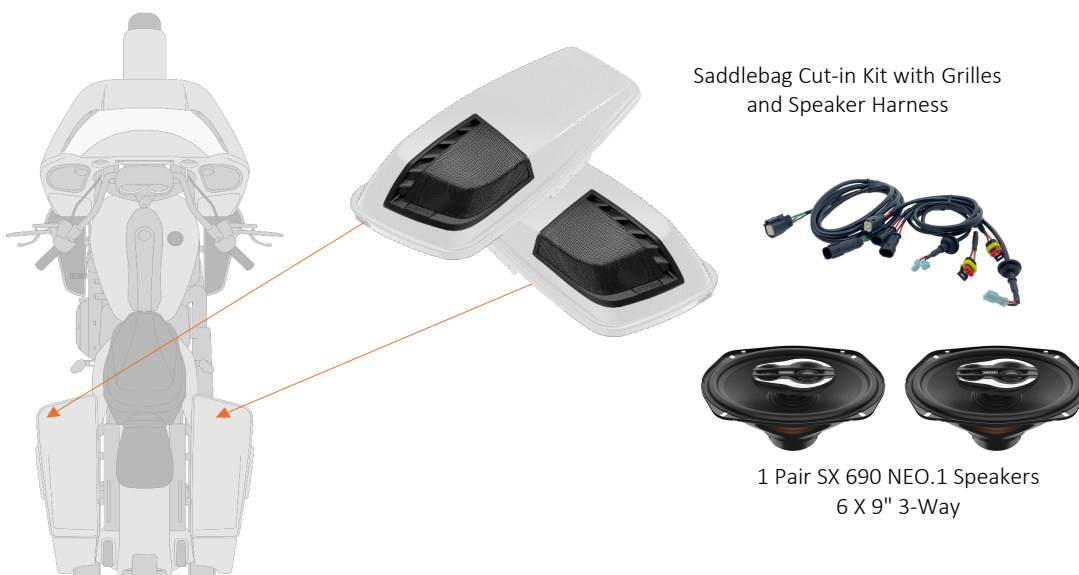

SPL SHOW

HERTZ SOUND PACKS

2014-2023 HARLEY-DAVIDSON® MOTORCYCLES

HSP3-14

MSRP: \$2,980.00

H-D® Motorcycles 2014 - 2024: Plug and Play 4 Speaker Kit with Saddlebag 6x9 Kit includes: SP4.900 amplifier, HD14DAMP amplifier mounting bracket, SX165 NEO Coax Speakers, SX690 NEO.1 Coax Speakers, HTHP14 T-Power Harness, HD14H Saddlebag Lid Kit with Speaker Harness and your choice of SG or RG speaker grilles.

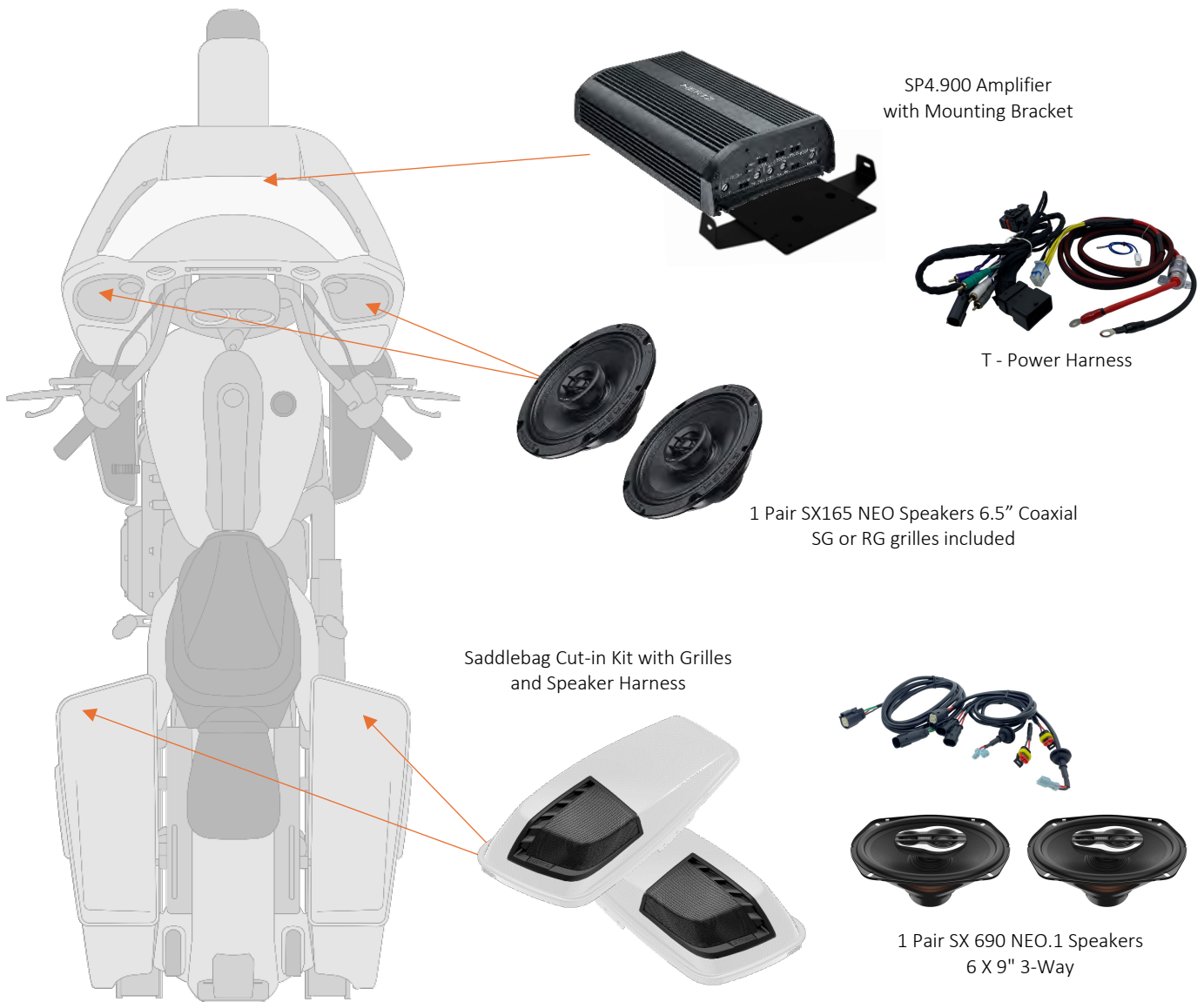

SPL SHOW

HERTZ SOUND PACKS

2014-2023 HARLEY-DAVIDSON® MOTORCYCLES

HSP2-14

MSRP: \$2,435.00

H-D® Motorcycles 2014 - 2023: Plug and Play Four Speaker Kit for bikes equipped with Touring Packs includes: SP4.900 amp, HD14DAMP amplifier mounting bracket, SX 165 NEO Coax Speakers, SV165 NEO Midrange Speakers and HTHP14 T-Power Harness and your choice of SG or RG speaker grilles.

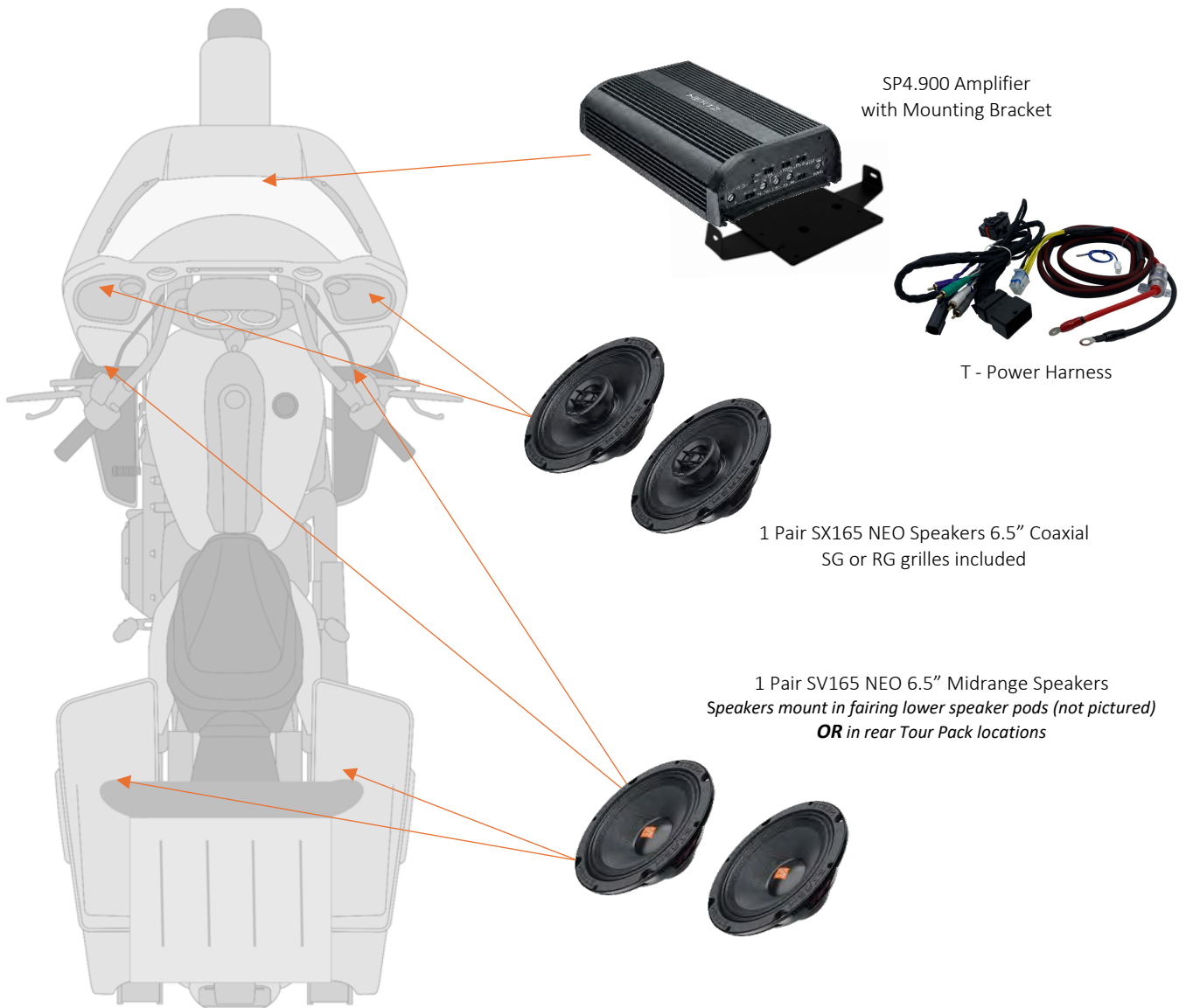

SPL SHOW

HERTZ SOUND PACKS

2014-2023 HARLEY-DAVIDSON® MOTORCYCLES

HSP1-14

MSRP: \$1,905.00

H-D® Motorcycles 2014 - 2023: Plug and Play Front Speaker Kit includes: SP4.900 amplifier, HD14DMAP amp mounting bracket, SX 165 NEO Coax Speakers and HTHP14 T-Power Harness and your choice of SG or RG speaker grilles.



HD14H 6x9

MSRP: \$1,075.00

2014 - 2023 Saddle Bag Lid Kit with Speaker Harness and SX690 NEO.1 3-Way Speakers.

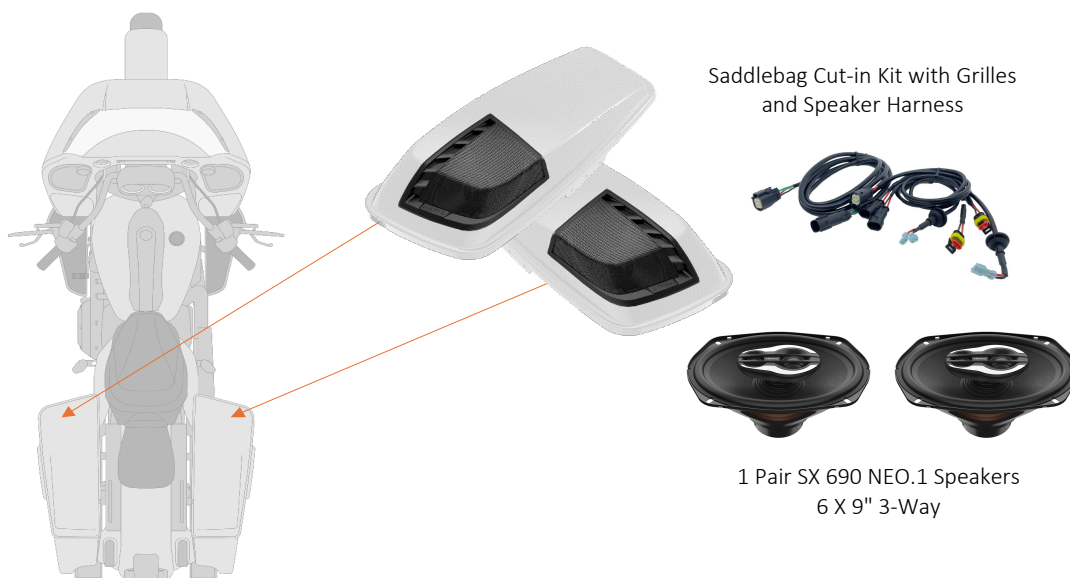

SPL SHOW

HERTZ SOUND PACKS

2024 + HARLEY-DAVIDSON® MOTORCYCLES

HSP3-24 A2B S3

MSRP: \$3,205.00

2024 A2B (for bikes equipped with Factory Stage 3 audio package) 4 Speaker Kit with HD A2B Module, SP4.900 amplifier, SX165 NEO Coax Speakers, SX690 H Coax Speakers, HHP14 Power and Ground Cable and Hog Badges for front and rear speaker grills.

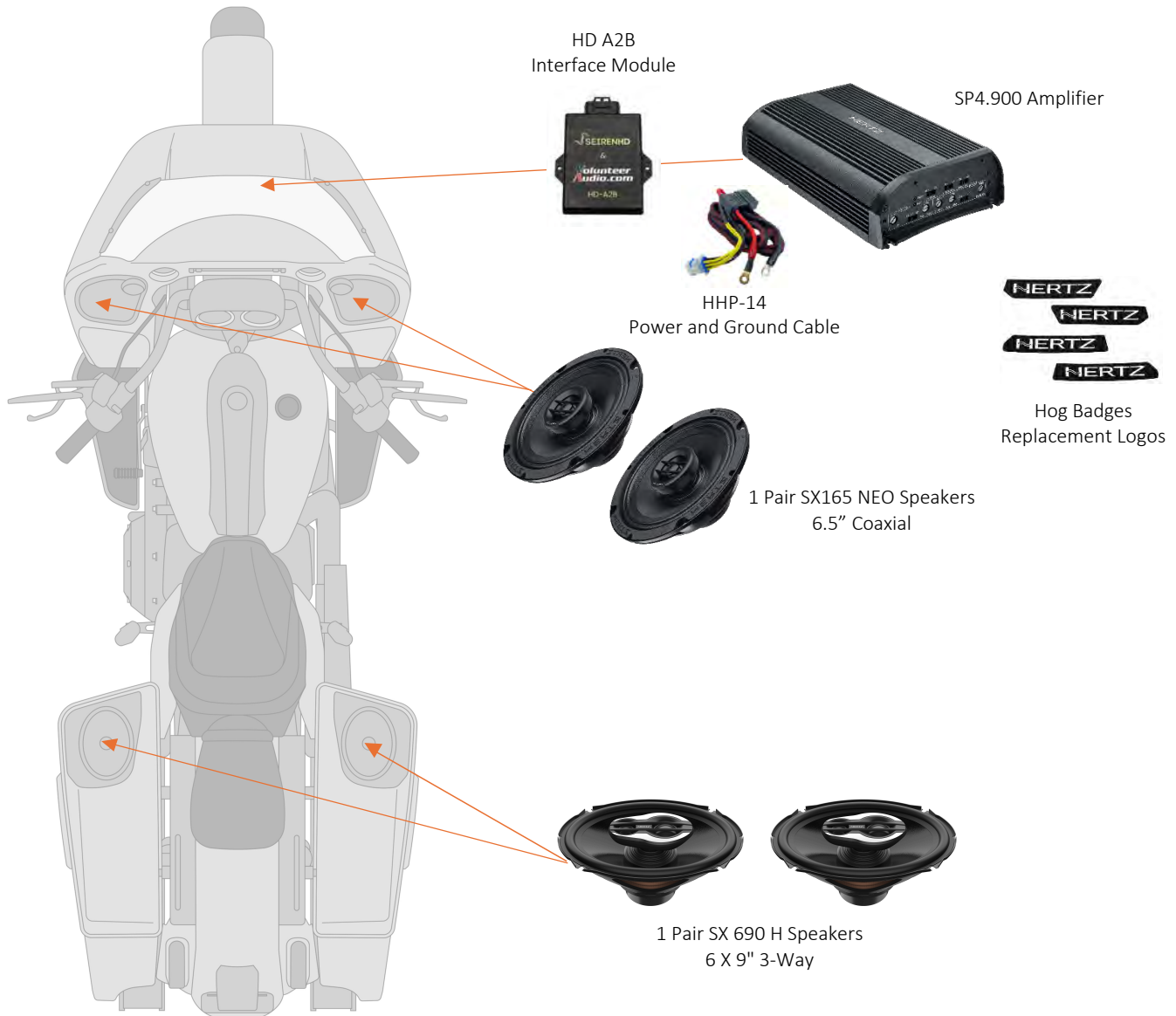

SPL SHOW

NERTZ SOUND PACKS

2024 + HARLEY-DAVIDSON® MOTORCYCLES

HSP3-24 A2B Base

MSRP: \$3,630.00

2024 A2B (for bikes that come with Base audio package) 4 Speaker Kit, HD A2B Module, SP4.900 amp, SX165 NEO Coax, SX690 H Coax, HD24H Saddlebag Lid Kit with Speaker Harness and HHP14 Power and Ground Cable. Hog Badges for the speaker grills.

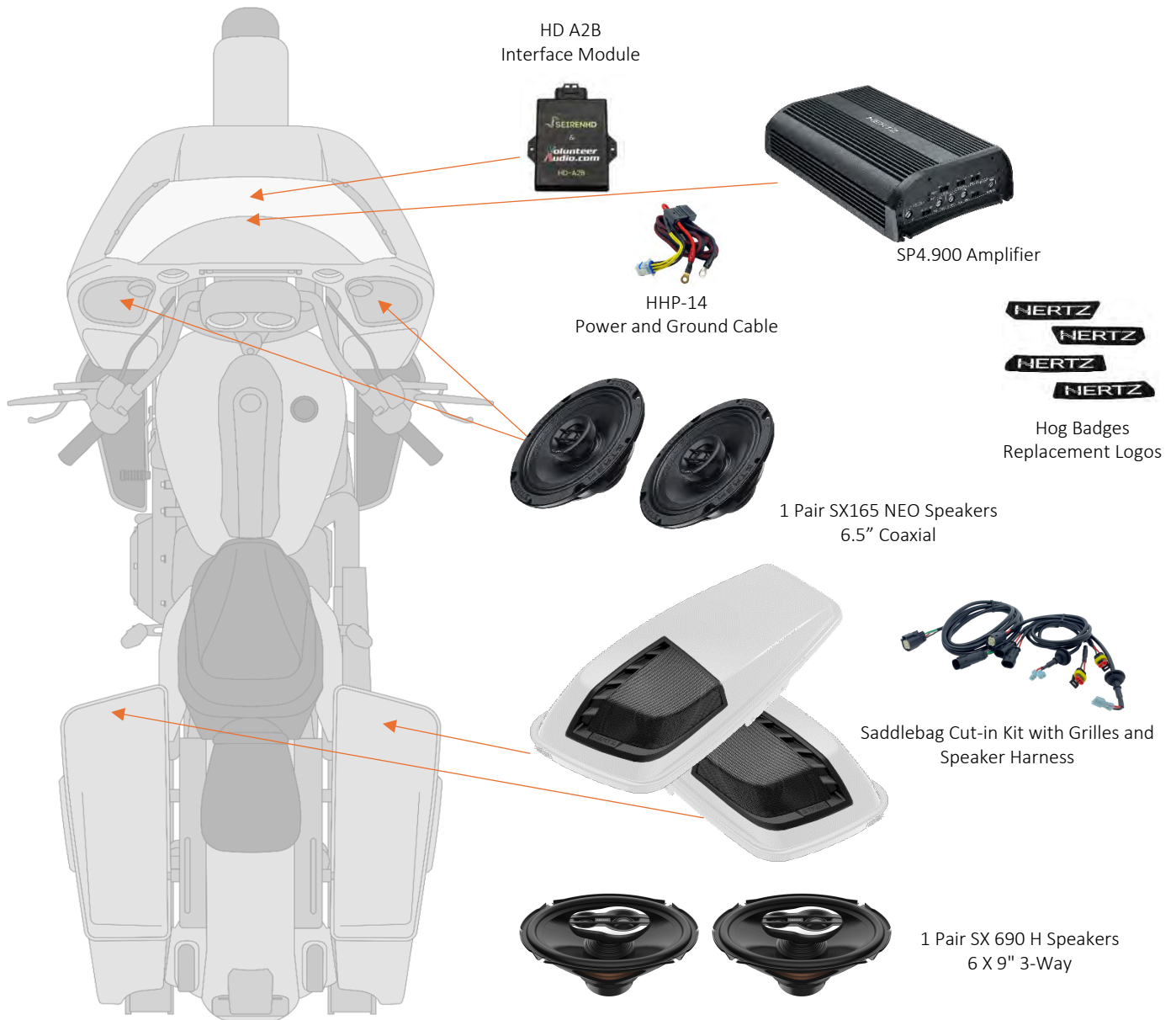

SPL SHOW

HERTZ SOUND PACKS

2024 + HARLEY-DAVIDSON® MOTORCYCLES

HSP2-24 A2B

MSRP: \$3,085.00

2024 A2B Tour Pack Kit - 4 Speaker Kit with HD A2B Module, SP4.900 amplifier, SX165 NEO Coax Speakers, SV165 NEO midrange speakers and HHP14 Power and Ground Cable. Hog Badges for the speaker grills.

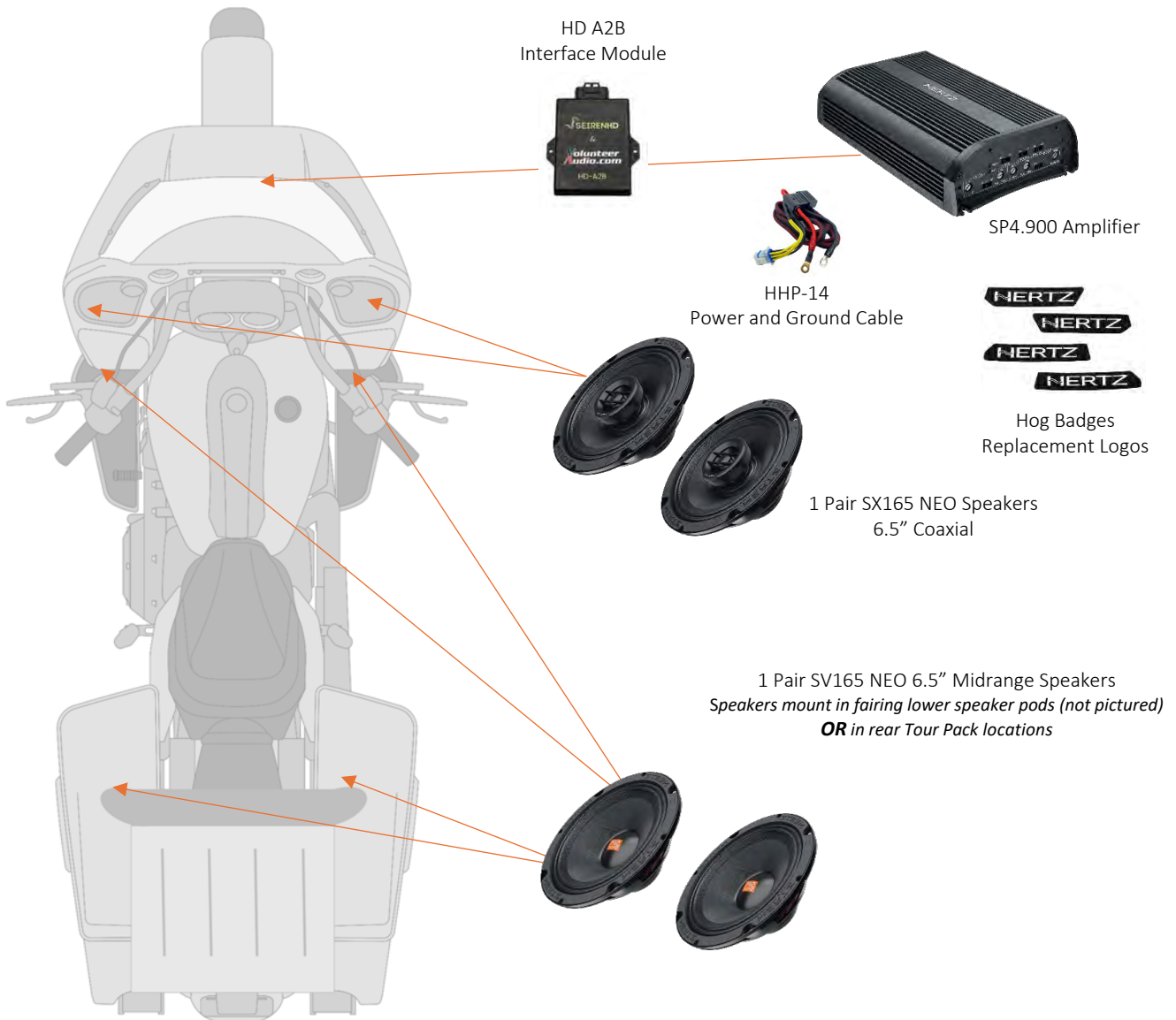

SPL SHOW

HERTZ SOUND PACKS

2024 + HARLEY-DAVIDSON® MOTORCYCLES

HSP1-24 A2B

MSRP: \$2,555.00

H-D® Motorcycles 2024+ 2 Speaker Kit with HD A2B Module, SP4.900 amplifier, SX165 NEO Coax, and HHP14 Power and Ground Cable. Hog Badges for the speaker grills.



HD24H 6x9

MSRP: \$1,075.00

2024+ Saddle Bag Lid Kit with Speaker Harness and SX690 H 3-Way Speakers.





Elettromedia-USA 16691 Noyes Ave Irvine, California 92606 USA 877.567.3030

HERTZ

SPL Show

A WALL OF SOUND
EVERYWHERE
YOU WANT!

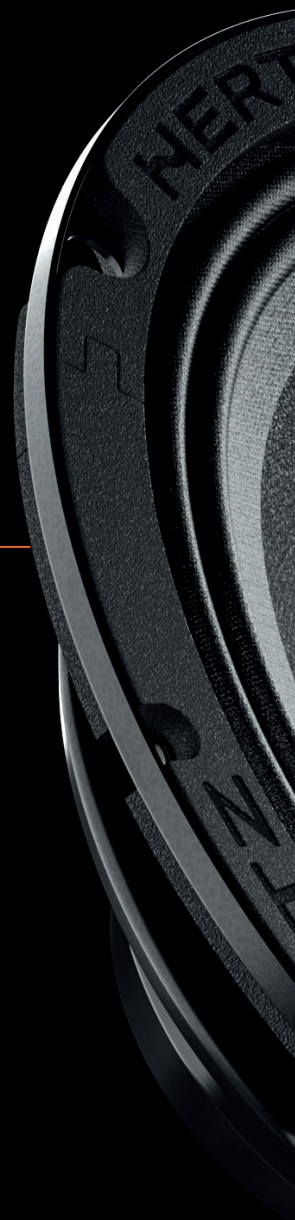



ST 25A NEO
HIGH EFFICIENCY
COMPRESSION DRIVER

100 W

NEO line bullet compression drivers are a totally new project, lighter and compact. They are available with 25 mm voice coil (ST 25 NEO) or 35 mm voice coil (ST 35 NEO),



ST 25K NEO
HIGH EFFICIENCY
COMPRESSION DRIVER

100 W

"Kit" version with metallic mesh grille, inline crossover filter included, torque key included.



ST NEO compression drivers feature superior performance thanks to the use of Neodymium N38 H for the motor units and a FEM (Finite Element Method) optimized driver/horn design.



Bullet tweeters are available in "Active" version (tweeter only), and in "Kit" version, with metallic mesh grille and inline crossover filter included.



ST 35A NEO
HIGH EFFICIENCY
COMPRESSION DRIVER

120 W



ST 35K NEO
HIGH EFFICIENCY
COMPRESSION DRIVER

120 W





SV 165 NEO
SPL MIDRANGE

400 W

-  UV RESISTANT
-  HUMIDITY RESISTANT
-  THERMAL SHOCK RESISTANT
-  VIBRATION PROOF

New SV 165 NEO and SV 200 NEO feature compact dimensions and light weight preserving excellent performance thanks to the use of Neodymium N38 H for the motor units.



The double layer copper voice coil, wound on polyamide former ensures unparalleled power handling.



SV 200 NEO
SPL MIDRANGE

400 W

SX 165 NEO and SX 200 NEO feature a large Hi-SPL 1.4" PEI dome tweeter with resettable solid-state protection circuit and a protective rubber gasket for high SPL and a safe outdoor use.



SX 165 NEO
SPL MIDRANGE

200 W

SX 200 NEO
SPL MIDRANGE

260 W



SX 690 NEO
SPL MIDRANGE

400 W

Grille provided

SX 690.1 NEO is a real beast with a Hi-SPL Mid-Hi unit based on a 1.4" dome tweeter and 1" dome super tweeter with a resettable solid-state protection circuit. The cone is made with nature-proof high stiffness pressed paper featuring innovative water/humidity resistance and anti-UV treatments.

SV SPL mid-range speakers are made to produce tremendous impact and dynamic, for your unlimited project.



SV 165.1
SPL MIDRANGE

400 W

SV SPL mid-range line employs a copper voice coil wound on a two-layer KSV former, for unheard-of thermal and mechanical capability also in extreme circumstances. The cone features a water repellent pressed paper membrane and paper dust caps, both robust and light weight, as well as double-wave damped fabric surrounds to ensure linearity even under extreme conditions, contributing to high SPL scores.



SV 200.1
SPL MIDRANGE

500 W



SV 200L
SPL WOOFER

500 W

The Hertz SV 200L car audio woofers was designed to offer superior performance in terms of both thermal and mechanical capability. The target has been fully hit since the woofer features a pure copper voice coil wound on KSV former, an oversized magnet and a vented bottom plate.



SV 250.1
SPL MIDRANGE

500 W



ADC
ADVANCE D-CLASS

SP is the first Hertz amplifier line featuring the renewed Hertz ADC (Advanced D-Class) output stage, reaching up to 85% efficiency and delivering an impressive power rating with an ultra-compact size of 211.6 (8.3) x 130 (5.1) mm (in.). Being ultra-compact with an impressive power, SP line amps are the ideal choice for Motorcycle application and for under-seat in sport cars and behind-seat installations in trucks.

IP55 aluminum chassis for maximum protection against humidity and external agents

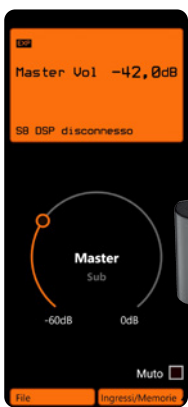

S8 DSP is the perfect match for SP amps for motorcycles application



The versatile crossover filters and control knob are all located on a single side, to allow an easy calibration when the product is installed. The filters section includes extremely flexible high-pass and low-pass crossovers, adjustable from 50 Hz to 5 kHz with 12 dB/Oct slope. Together with a bass-boost control (45 Hz, 0:8 dB), they allow both front channels to be configured for full-range operation, or for use with a subwoofer and related speakers. The high-pass crossover can also be used to optimize the performance of SPL Show NEO high-efficiency coaxial speakers, the perfect partners for the SP line amps.

SP 4.900

D-CLASS FOUR CHANNEL AMPLIFIER
1000 W



POWER SUPPLY	
Nominal power supply voltage	11 ÷ 15 VDC
Pulse Operating voltage	6 ÷ 16 VDC
Idling current	1.1 A
Idling current when off	0.03 mA
Consumption @ 14.4 VDC, MIN load impedance (Max Musical Power)	50 A
Remote IN	6 ÷ 15 VDC (9 mA)
DC-REM - Remote Turn on by SPK DC from OUTPUT BTL speakers	3.5 ÷ 7 VDC

AMPLIFIER STAGE	
Distortion - THD @ 1 kHz, 40, 70% Rated Power	0,02%
Damping factor @ 1 kHz, 40, 2 VRMS	200
Bandwidth @ -3 dB	10 Hz ÷ 35 kHz
S/N ratio (A weighted @ 1 V Input)	105 dBA
Pre-In sensitivity	0.6 ÷ 6 VRMS
Speaker-In sensitivity	2.2 ÷ 22 VRMS
Minimum load impedance	@ 4Ch: 2Ω
	@ 3Ch: 2Ω + 2Ω + 4Ω
	@ 2Ch: 4Ω
Output power (RMS) @14.4 VDC, 1% THD:	
4Ch	160 W x 4 (4Ω)
4Ch	250 W x 4 (2Ω)
3Ch	160 W x 2 (4Ω) + 500 W x 1 (4Ω)
3Ch	250 W x 2 (2Ω) + 500 W x 1 (4Ω)
2Ch	500 W x 2 (4Ω)

CEA SPECIFICATION		
	Output power @ 4Ω 1% THD+N, 14.4 V	145 W x 4 Ch
	SN ratio (ref. 1 W output)	81 dBA

INPUTS / OUTPUTS / FILTERS	
Inputs	Pre IN / Speaker IN
Ch 1-2 Filters:	Full
	Hi-pass: 50 ÷ 5k Hz @ 12 dB/Oct.
	Lo-pass: 50 ÷ 5k Hz @ 12 dB/Oct.
Ch 3-4 Filters:	Full
	Hi-pass: 50 ÷ 5k Hz @ 12 dB/Oct.
	Lo-pass: 50 ÷ 5k Hz @ 12 dB/Oct.
Bass Boost 45Hz (adjustable)	OUT 3 -4 (0 ÷ 8 dB) [LP = ON only]

GENERAL	
IP Rating	IP55
Operating Temperature Range	0°C (32°F) to 55°C (131°F)

SIZE / WEIGHT	
Max size (mm/inch)	211.6 x 130 x 49 / 8.33 x 5.118 x 1.929
Weight (kg/lbs)	2.15 / 4.74



1. Up to 85% efficiency thanks to ADC (Advanced D-Class) output stage
2. USS (Universal Speakers Simulators) allows SP 4.900 to work with head units featuring the "speaker load detection" circuit
3. 160 W RMS x 4 (4Ω) with ultra-compact size 211.6 x 130 x 49 / 8.3 x 5.1 x 1.9 (mm/inch)
4. IP55 aluminium chassis for maximum protection against humidity and external agents
5. No cooling fan to prevent internal accumulation of dirt
6. Sealed power cord, line inputs and speaker outputs to prevent oxidation
7. Crossovers filters and controls on a single side to facilitate calibration when the product is installed

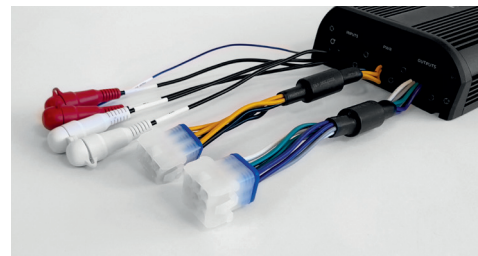

Sealed connectors

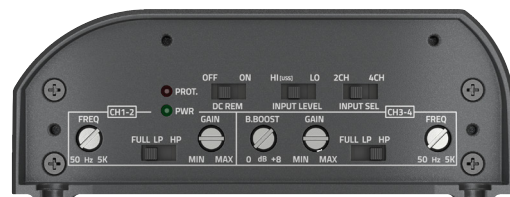

Maximum versatility

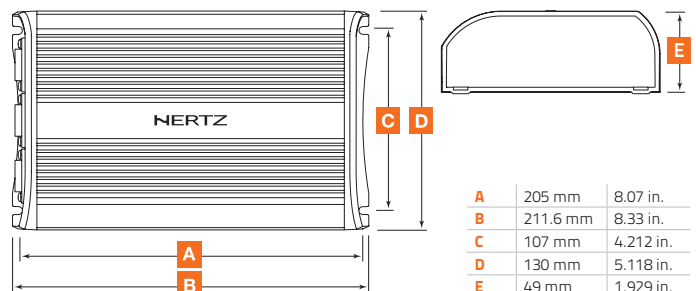

S8 DSP

DIGITAL INTERFACE PROCESSOR

hertz-audio.com

HERTZ

S8 DSP

DIGITAL INTERFACE PROCESSOR

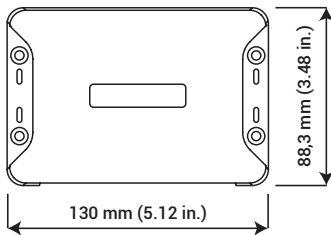

1. Small and weatherproof - perfect for motorcycles

- Compact size featuring all connections on one side to be installed anywhere
- Anti-corrosion-treated PCB to ensure years of listening pleasure in open nature
- Three different application setups: Car, Motorcycle, Free placement (boat, van, pick-up)
- Party & Ride presets, to optimize the sound performance in all conditions

2. Configurable with a PC, a Mac, an Android device, or an iOS device

- iOS/Android control APPs (Bluetooth 5.0)
- DRC control over app from iOS/Android devices

3. Powerful DSP with the excellent sound quality you expect from Hertz

- Hi-Res audio (96 kHz/24-bit native resolution) for unparalleled audio quality
- 6-channel SPEAKER IN (2,5 – 21 Vrms) on a dedicated socket with built-in USS (Universal Speakers Simulator)
- SPDIF coaxial input (up to 24bit/96KHz)
- 8-channel / 4Vrms-capable RCA outputs
- Signal Output Active Limiter prevents clipping

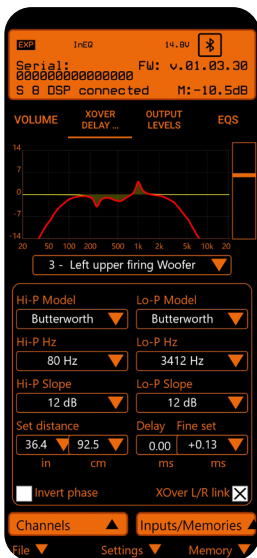

Crossover filter setup

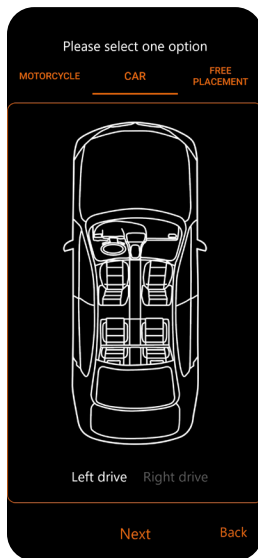

Car channel setup

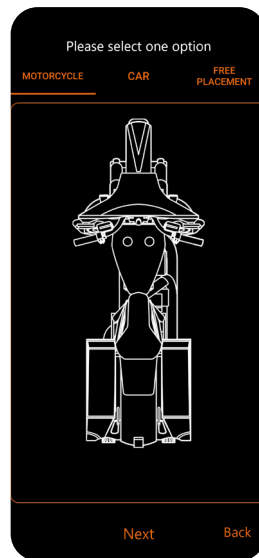

Motorcycle channel setup

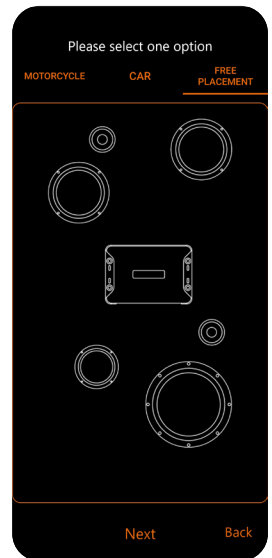

Free placement setup



S8 DSP

DIGITAL INTERFACE PROCESSOR

hertz-audio.com

HERTZ

S8 DSP

DIGITAL INTERFACE PROCESSOR

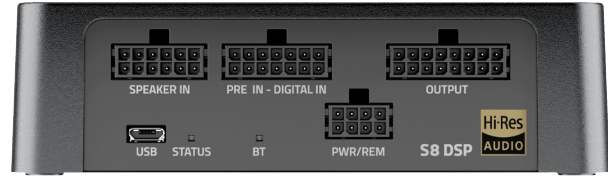

All connectors in one side



- 6-channel PRE IN (0,8 - 6Vrms)
- 6-channel SPEAKER IN (2,5 - 21Vrms) (with USS)
- SPDIF coaxial input (up to 24bit/96KHz)
- ART™ - Automatic Remote Turn-On/Off with Speaker-In
- 8-channel / 4Vrms capable RCA outputs
- 7-band EQ for each input channel
- Input-Output Routing Matrix setup by Control APP/Software
- Start&Stop Compliance to 6V
- 4 Presets selection by wire
- iOS/Android Control APPs
- Windows/Mac Control Software

POWER SUPPLY

Nominal Power supply voltage / fuse:	7 ± 20 VDC / 1A
Pulse operating voltage:	5 ± 24 VDC
Idling current:	0.34 A
OFF current (ART™= OFF):	<80 µA
OFF current (ART™= ON):	<80 µA
Remote IN:	6 ± 20 VDC (10 mA)
Remote OUT:	4 ± 20 VDC (150 mA)
ART - Automatic Remote Turn on/off from BTL speaker outputs (selectable):	1.5 ± 7 VDC

SIGNAL STAGE

Resolution:	24bit
Sampling Rate	96 KHz
Distortion - THD @ 1 kHz, 1 VRMS Output:	0.004 %
Bandwidth @ -3 dB:	10 Hz ÷ 40 kHz
S/N ratio @ A weighted, 4 V Output, 1 V Master Input:	100 dBA
S/N ratio @ A weighted, 4 V Output, 1 V Digital IN Input:	112 dBA
Channel Separation @ 1 kHz:	97 dBA
Input sensitivity Pre-In:	0.8 ÷ 6 VRMS
Input sensitivity Speaker-In:	2.5 ± 21 VRMS
Input Impedance:	38 kΩ (Pre IN/AUX) 4.7 Ω (Speaker IN)
Max output Level 0,1%THD:	4 V

INPUTS STAGE

Analog inputs management	Audio input routing matrix type
Low level (Pre In):	6 RCA inputs
Hi-Level:	6 Wired inputs
Digital IN:	Coaxial S/PDIF; up to 24bit 96KHz; Extra Gain+3dB, +6dB.

OUTPUT STAGE

Low level (Pre Out):	8 RCA outputs
Output Equalizer	15 poles Parametric EQ; ±12 dB; 20 ±20 kHz
Output Signal Limiter	Yes (Selectable)

CONNECTION

From / to personal computer:	1 x micro USB
Bluetooth data connectivity (no audio streaming):	BT 5.0 (BLE)

CROSSOVER

Filter type:	Full / Hi-Pass / Low-Pass / Band Pass
Filter mode and slope:	Linkwitz @ 12 / 24 dB Butterworth @ 6 / 12 / 18 / 24 / 30 dB Bessel @ 6 / 12 / 18 / 24 / 30 dB
Crossover frequencies:	20 ÷ 20 k Hz (120 step)
Phase control:	0° / 180°

EQUALIZER (20 HZ ÷ 20 kHz)

Inputs:	Parametric EQ: +12 dB ÷ -12 dB; 7 poles (for each input channel)
Outputs:	Parametric EQ: +12 dB ÷ -12 dB; 15 poles (for each output channel)

GENERAL

Memory Preset:	4 x Preset
Memory Preset selection:	Through the Control Software or by wire
Input Selection:	Through the Control Software or by wire

TIME ALIGNMENT

Distance:	0 ÷ 471.5 cm / 0 ÷ 185.5 in.
Delay:	0 ÷ 13.58 ms
Step:	0.02 ms, 0.7 cm / 0.27 in.

GENERAL REQUIREMENTS

PC connections:	1 x USB 1,1 / 2,0 / 3,0 Compatible or Bluetooth 5.0 BLE
Software / PC requirements:	Microsoft Windows (32/64 bit): Windows 10 (USB and BT BLE) Windows 11 (USB and BT BLE) Mac Os: 10.13 High Sierra or later (USB and BT BLE)
Minimum mobile device requirements:	Android OS 7 or later (USB OTG and BT BLE), iOS 12 or later (BT BLE)
Video Resolution with screen resize	min. 1024 x 600
Ambient operating temperature range	0° C to 55° C / (32° F to 131° F)

SIZE / WEIGHT

Max size W x H x D (mm/inch):	130 x 37 x 88.3 / 5.12 x 1.45 x 3.48
Weight (kg/lb):	0.66 / 1.45

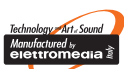

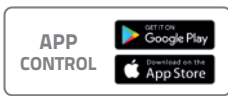

Every parameter of the DSP is controlled wirelessly using the CONFIGURATOR App for Apple and Android tablets and smartphones, thanks to the integrated Bluetooth® 5.0 receiver. PC Software is available for both PC and Apple OS. Four configuration presets are supported, so you can choose the ideal setup for every listening condition.

